

THIS DOCUMENT IS THE PROPERTY OF LYTRON, INC., AND REPRESENTS A PROPRIETARY ARTICLE ON WHICH LYTRON, INC. RETAINS ANY AND ALL PATENT AND OTHER RIGHTS, INCLUDING EXCLUSIVE RIGHTS OF USE AND/OR MANUFACTURE AND/OR SALE. POSSESSION OF THIS DOCUMENT DOES NOT CONVEY ANY PERMISSION TO REPRODUCE THE DOCUMENT OR MANUFACTURE THE ARTICLE OR ARTICLES SHOWN THEREIN.

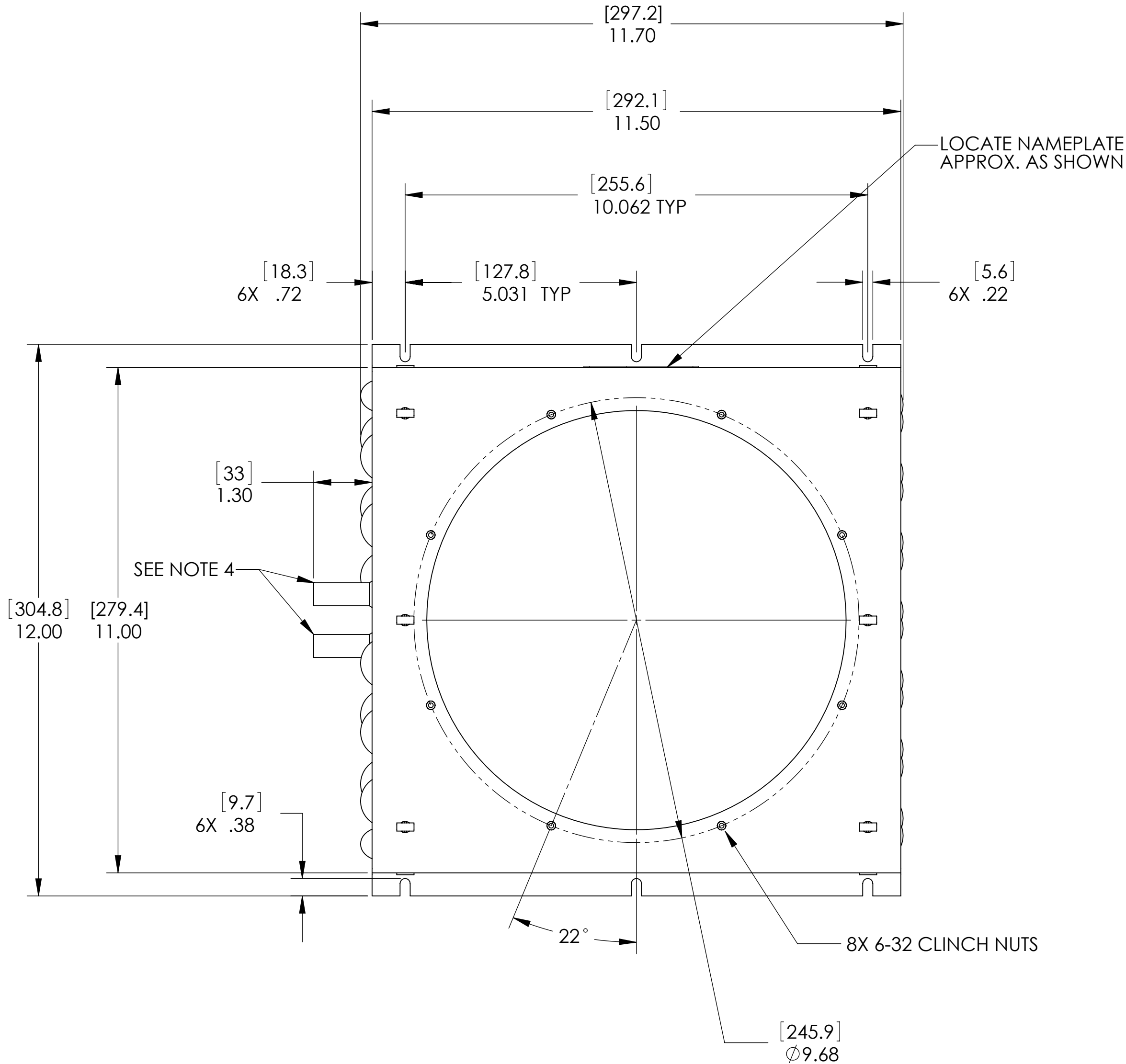
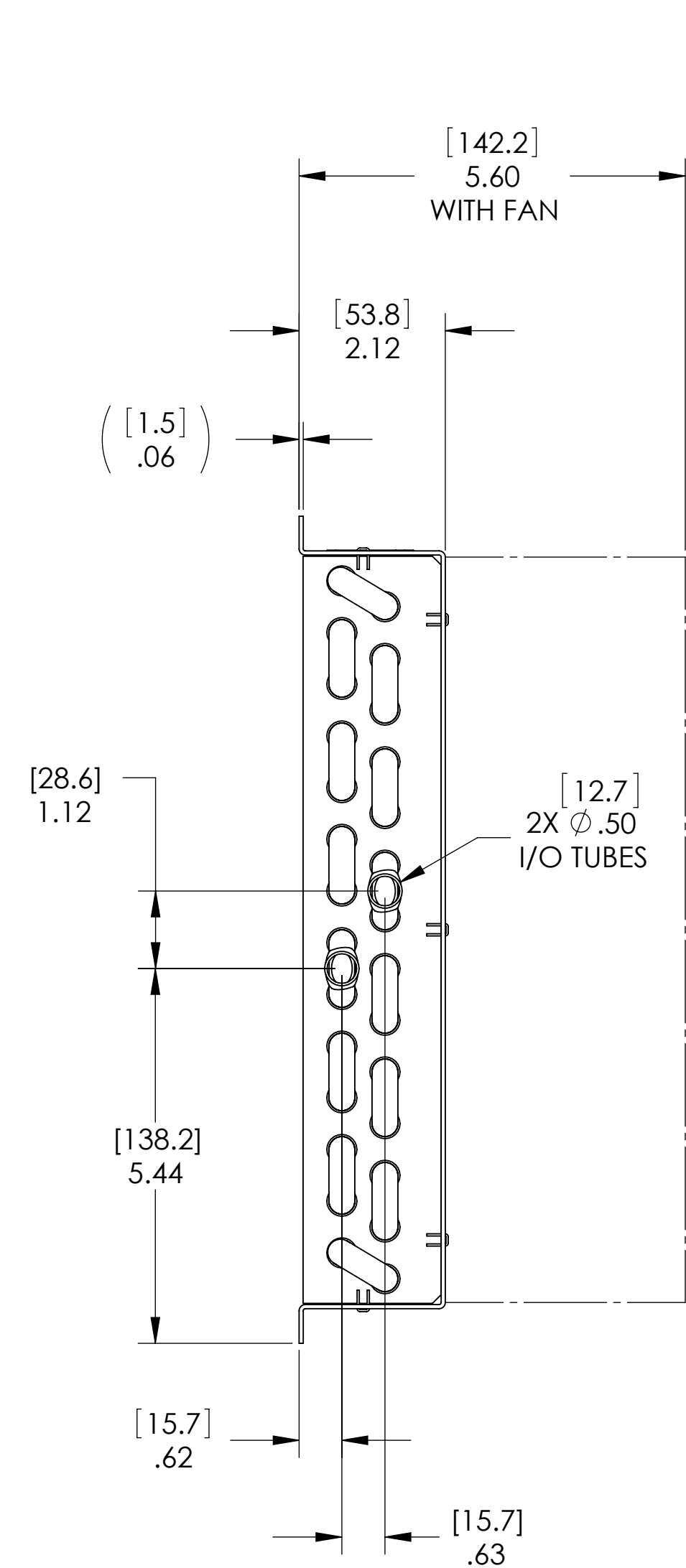

6310G3SB

MATERIAL	
FITTINGS	COPPER
OUTER FIN & TUBE	COPPER
FRAME	ALUMINUM

- NOTES:
- DIMENSIONS IN [] ARE IN MILLIMETERS.
 - LEAK TEST- PNEUMATIC PRESSURE TEST AT 150 PSIG.
 - FINISH WILL BE AS FOLLOWS: SEMI GLOSS BLACK ACRYLIC PAINT.
 - 1" OF END OF FITTINGS TO BE FREE OF PAINT.

UNLESS OTHERWISE SPECIFIED		DRN	DATE	LYTRON INCORPORATED WOBURN, MASSACHUSETTS			
ANGULAR DIMENSIONS ± 5° SURFACE ROUGHNESS 125/ (3.2 m) BREAK EDGES 0.10 (2.5mm) MAX. REMOVE ALL BURRS		CHK'D		DRAWING TITLE HEAT EXCHANGER CORE CODE: L14-2-16-10.00			
		APPV'D					
		APPV'D					
TOLERANCE ON DECIMALS		APPV'D		DO NOT SCALE THIS DRAWING			
.X .XX .XXX INCH ±.X ±.XX ±.010 mm ±XX ±XX ±XXX		APPV'D					
THIRD ANGLE PROJECTION DIMENSIONS AND TOLERANCING ARE PER ANSI STD Y14.5		MAT'L	COPPER CORE AND AL SHEET METAL	SIZE	FSCM NO.	DRAWING NO.	REV
		FINISH	NONE	D	11245	S-6310G3SB	K
		SCALE	1/2	WT.	SHEET 1 OF 1		