

THIS DOCUMENT IS THE PROPERTY OF LYTRON, INC. AND REPRESENTS A PROPRIETARY ARTICLE ON WHICH LYTRON, INC. RETAINS ANY AND ALL PATENT AND OTHER RIGHTS, INCLUDING EXCLUSIVE RIGHTS OF USE AND/OR MANUFACTURE AND/OR SALE. POSSESSION OF THIS DOCUMENT DOES NOT CONVEY ANY PERMISSION TO REPRODUCE THE DOCUMENT OR MANUFACTURE THE ARTICLE OR ARTICLES SHOWN THEREIN.

LABEL MARKED WITH FOLLOWING:
LYTRON P/N
SERIAL NO.
(LOCATE APPROXIMATELY AS SHOWN)

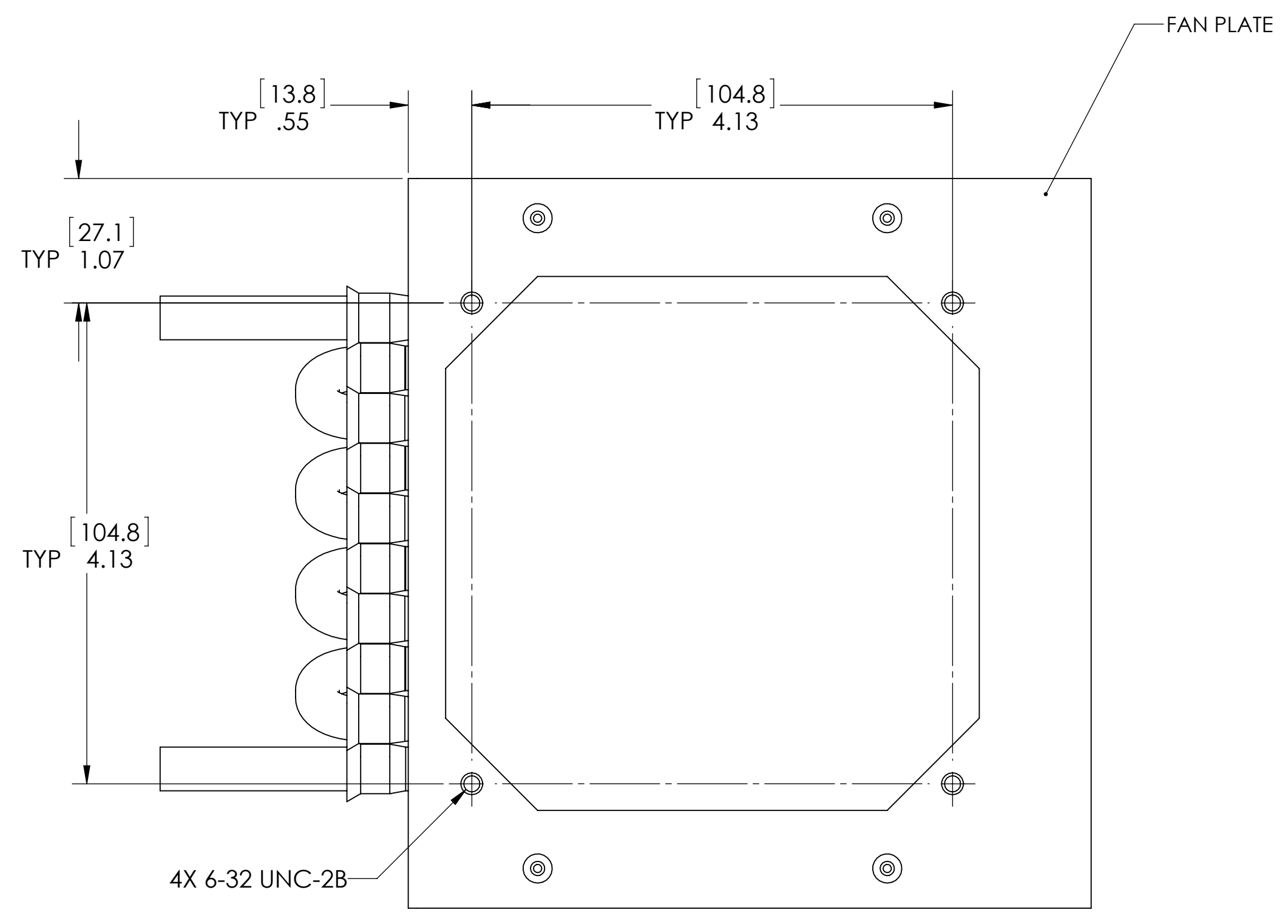
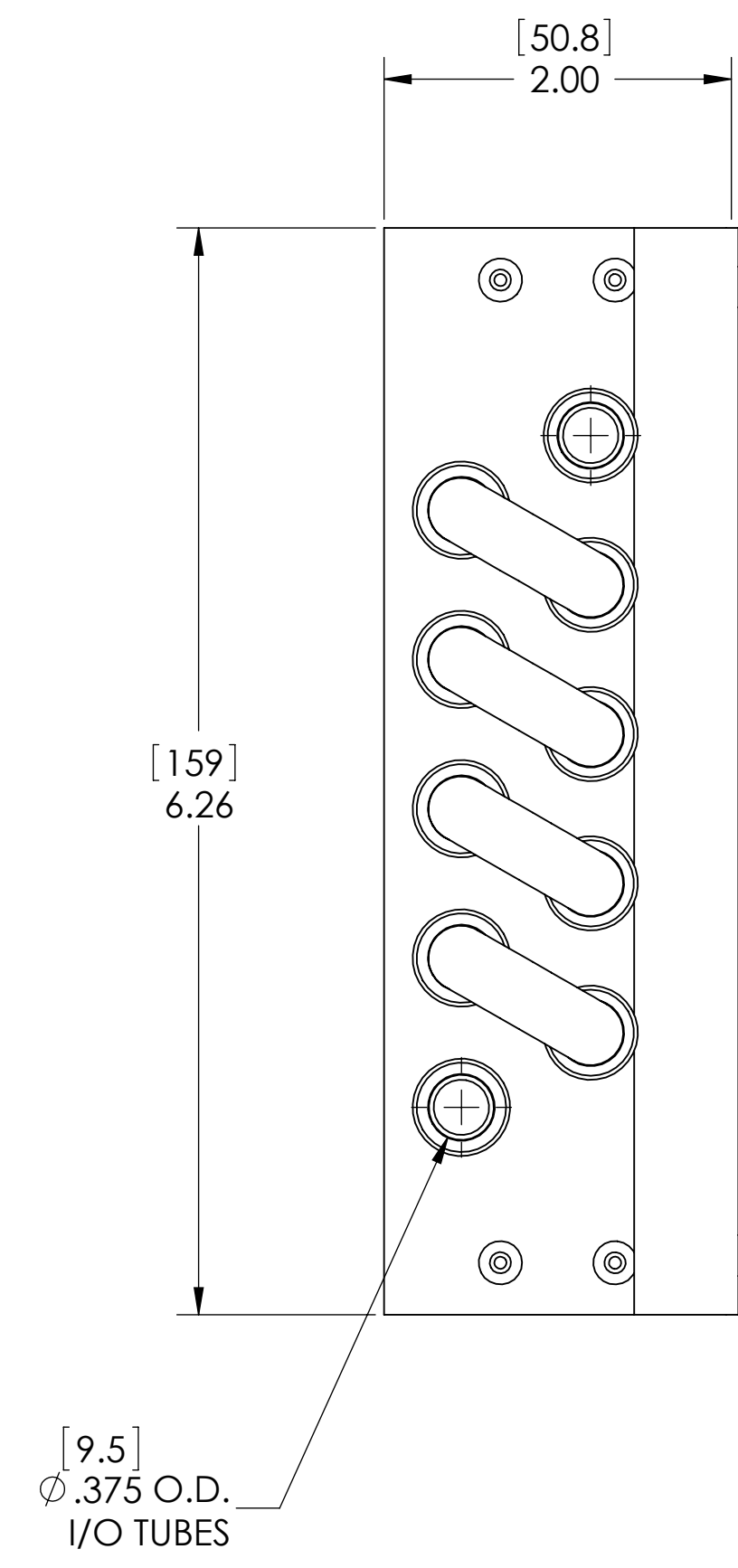
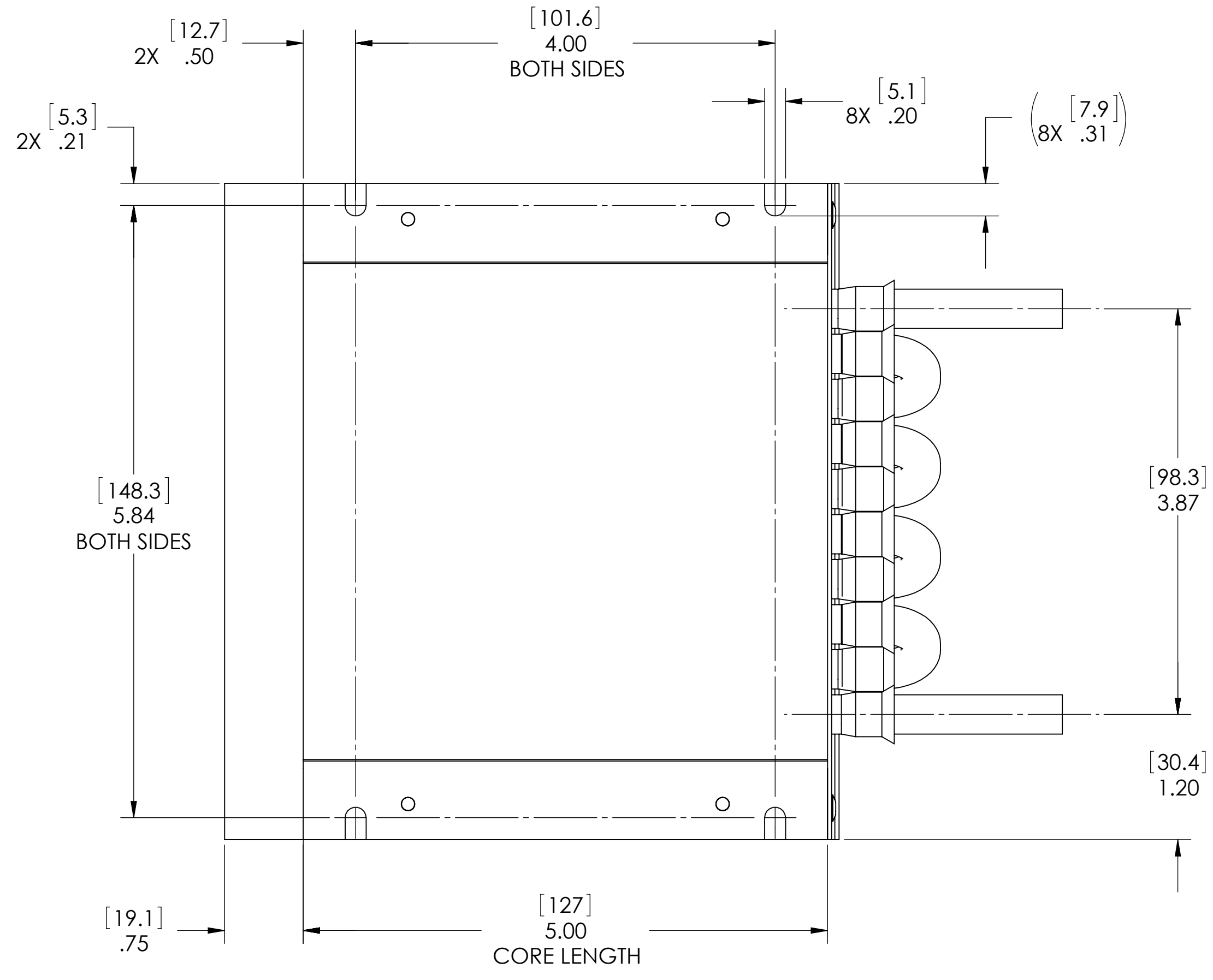
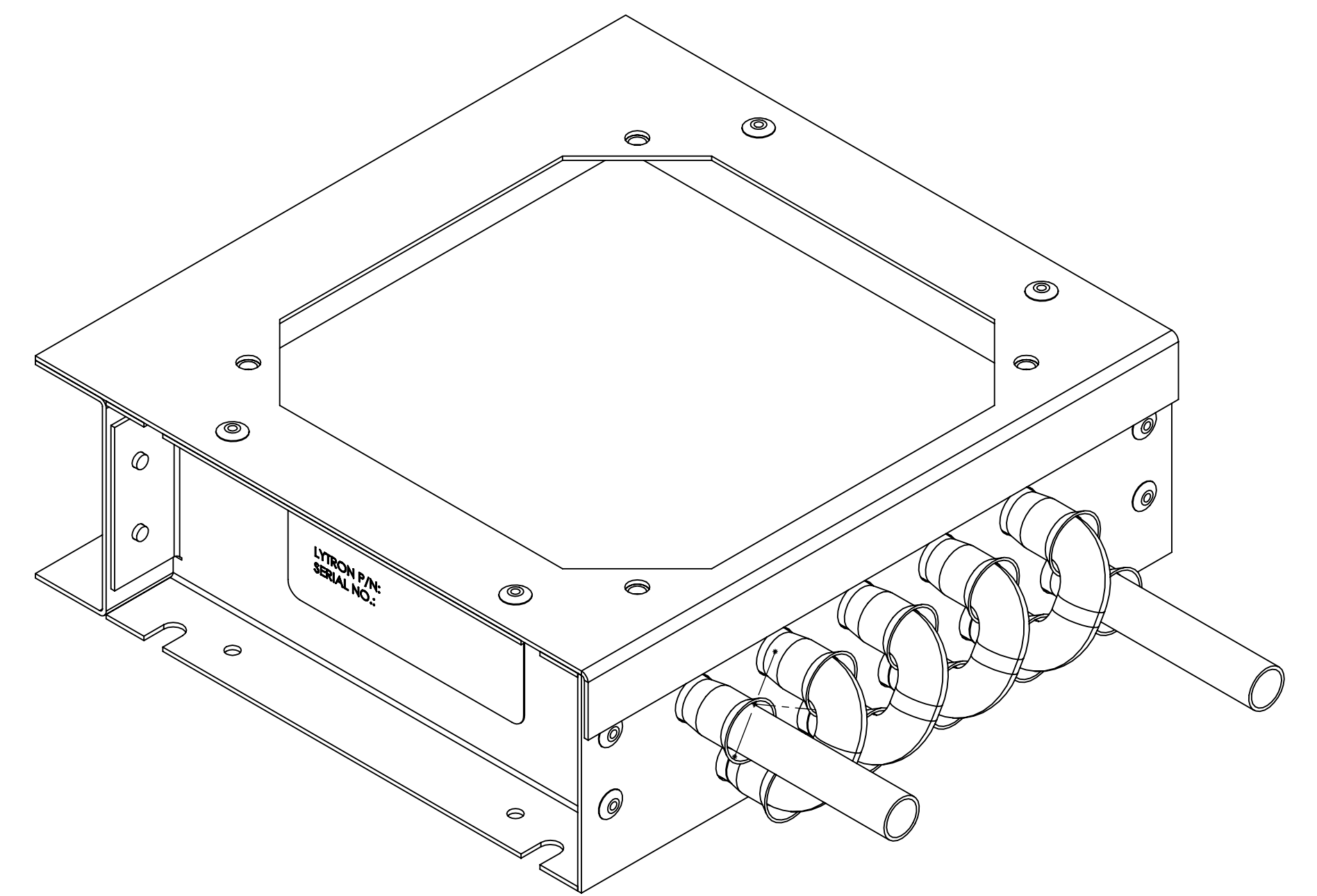
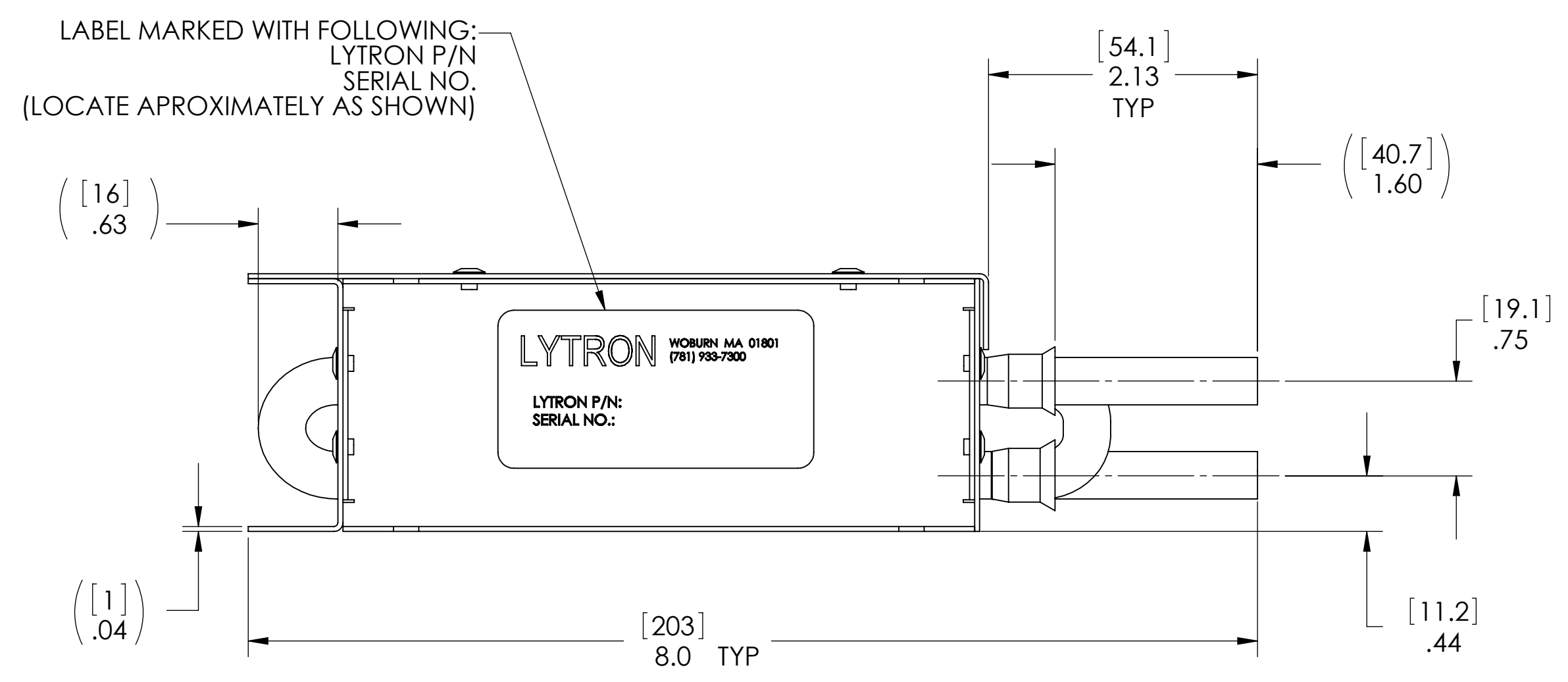

M05-050SB1

- NOTES:
1. PRESSURE TEST ASSEMBLY AT 150 PSIG.
2. DIMENSIONS IN [] ARE IN MILLIMETERS.

MATERIAL	
TUBING	COPPER
OUTER FIN	ALUMINUM
FITTINGS	COPPER
FRAME	GALVANIZED STEEL

UNLESS OTHERWISE SPECIFIED		REDRAWN	DATE	Lytron Inc. 55 Dragon Ct. Woburn Ma. 01801	
ANGULAR DIMENSIONS ARE ±5° SURFACE ROUGHNESS 125 / (3.2 um) BREAK EDGES 0.10 MAX. REMOVE ALL BURRS		DRAWN		DRAWING TITLE	
TOLERANCE ON DECIMALS		APPROVED		HEAT EXCHANGER ASSY.	
X .XX .XXX		APPROVED		DO NOT SCALE THIS DRAWING	
INCH ±.1 ±.06 ±.020		APPROVED		SIZE	FSCM NO.
(mm) ±.20 ±.XX ±.XXX		MATERIAL SEE CHART		D 11245	DRAWING NO.
THIRD ANGLE PROJECTION		FINISH NONE		S-S-M05-050SB1	REV
DIMENSIONS AND TOLERANCING ARE PER ANSI STD Y14.5		SCALE 1/1		WT.	SHEET 1 OF 2