

THIS DOCUMENT IS THE PROPERTY OF LYTRON, INC. AND REPRESENTS A PROPRIETARY ARTICLE ON WHICH LYTRON, INC. RETAINS ANY AND ALL PATENT AND OTHER RIGHTS, INCLUDING EXCLUSIVE RIGHTS OF USE AND/OR MANUFACTURE AND/OR SALE. POSSESSION OF THIS DOCUMENT DOES NOT CONVEY ANY PERMISSION TO REPRODUCE THE DOCUMENT OR MANUFACTURE THE ARTICLE OR ARTICLES SHOWN THEREIN.

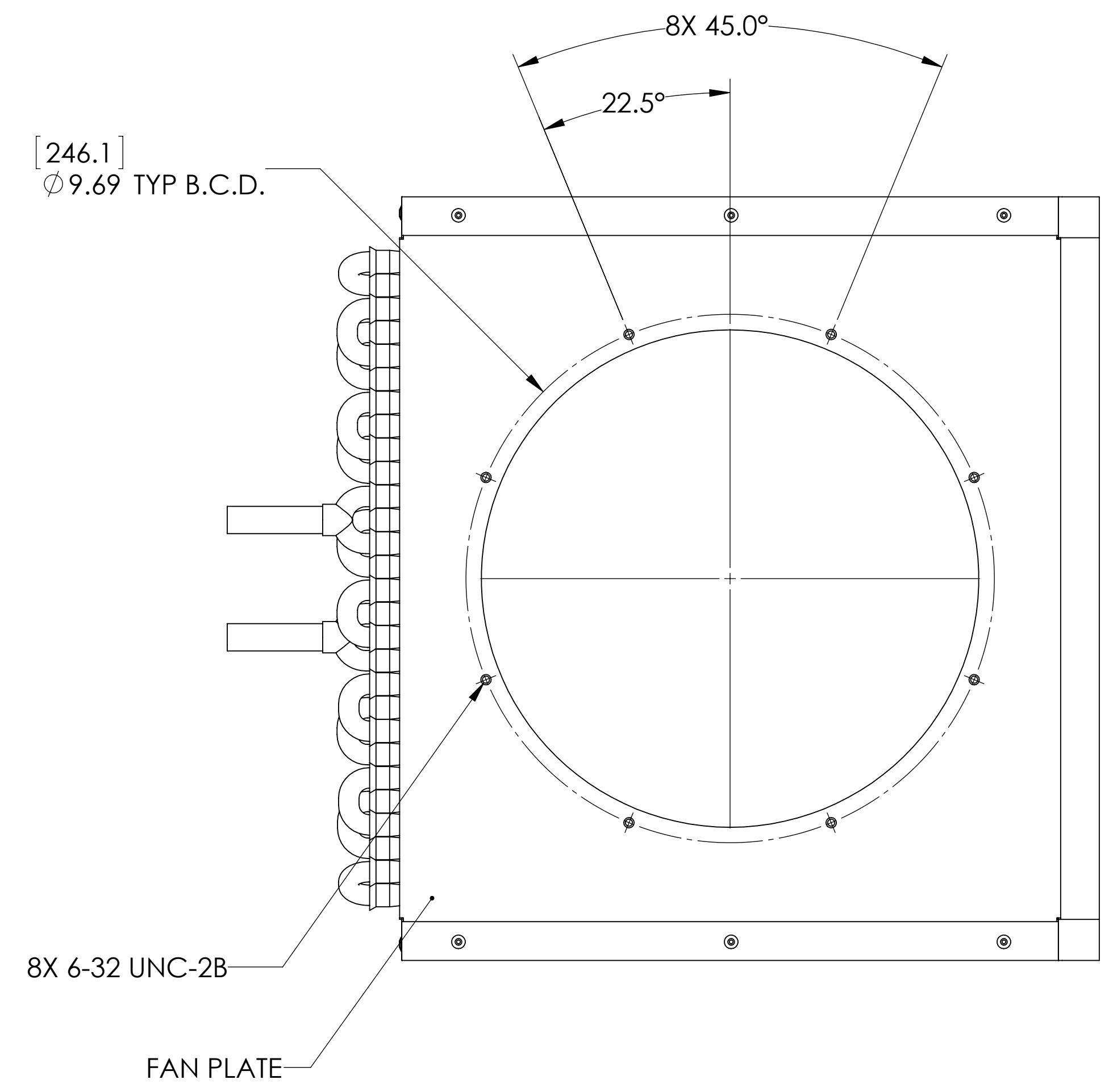
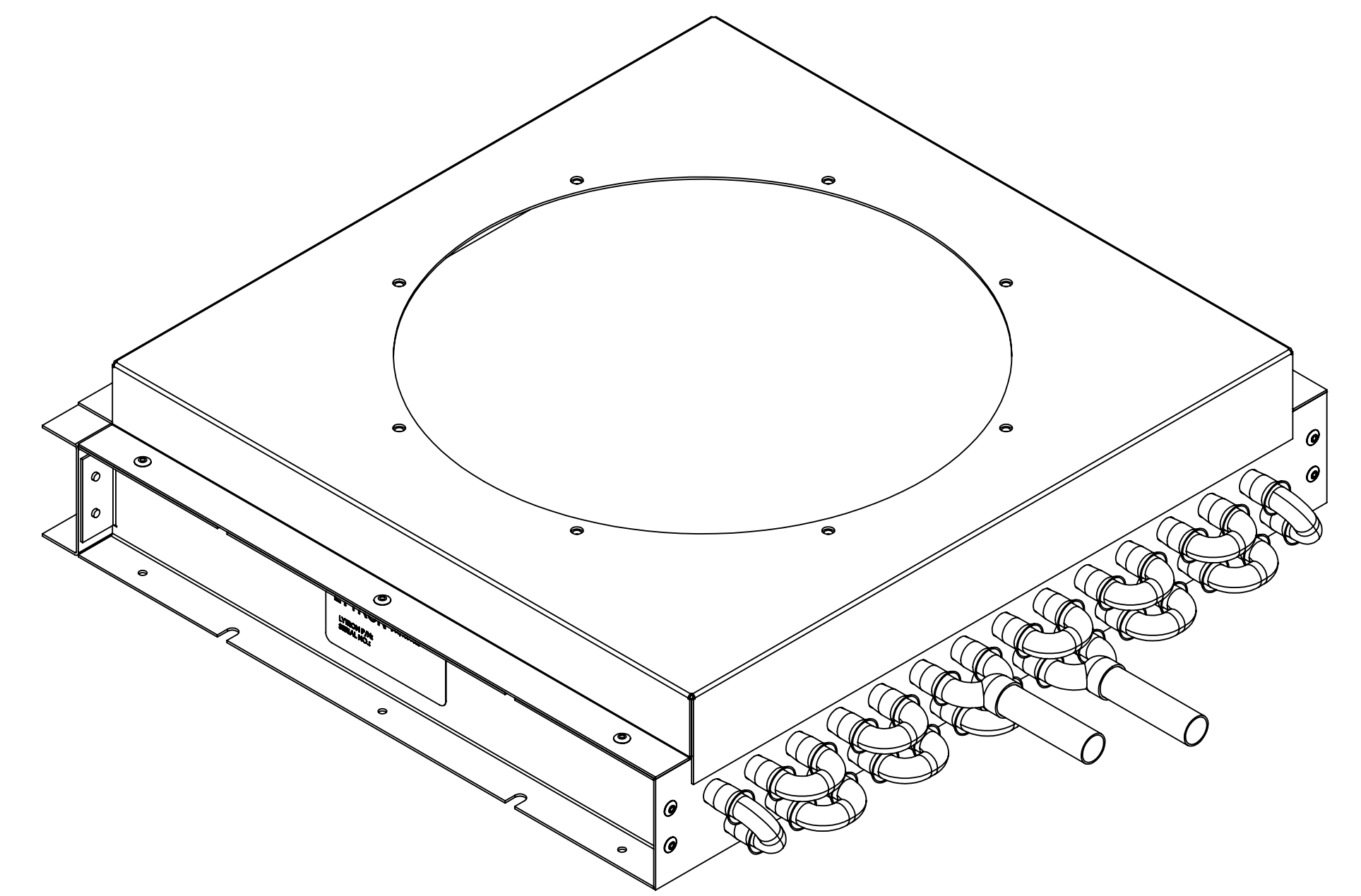
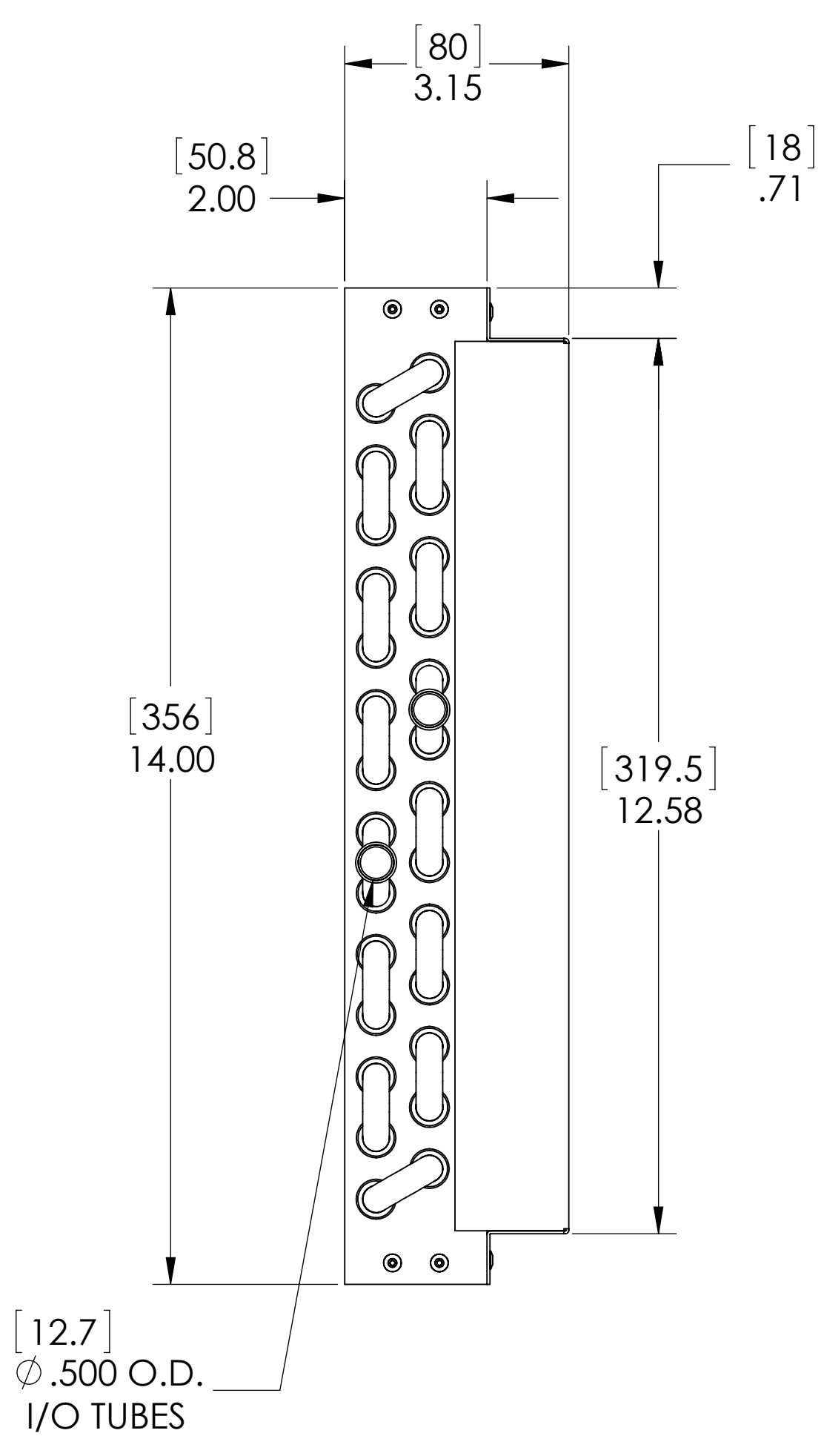
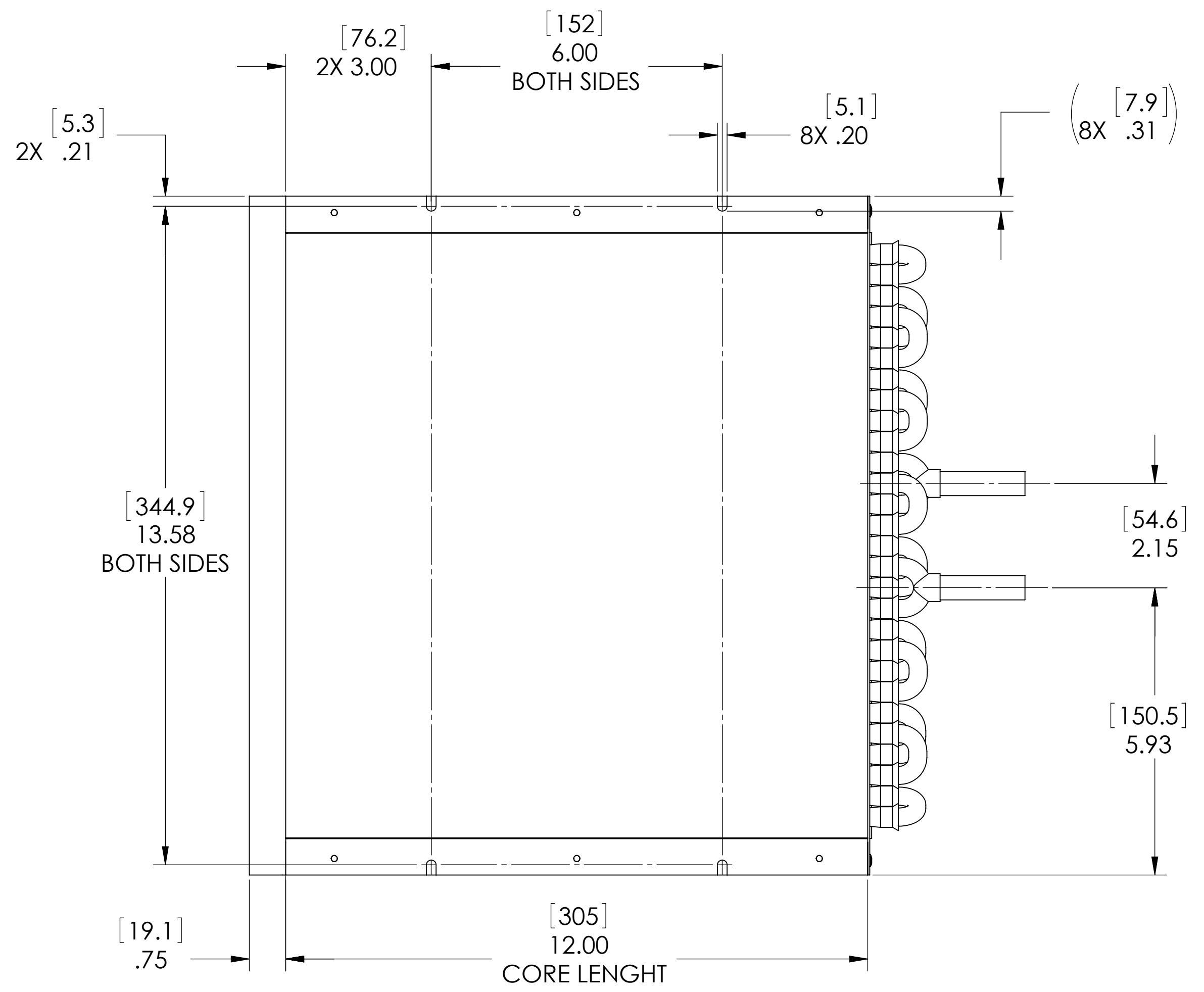
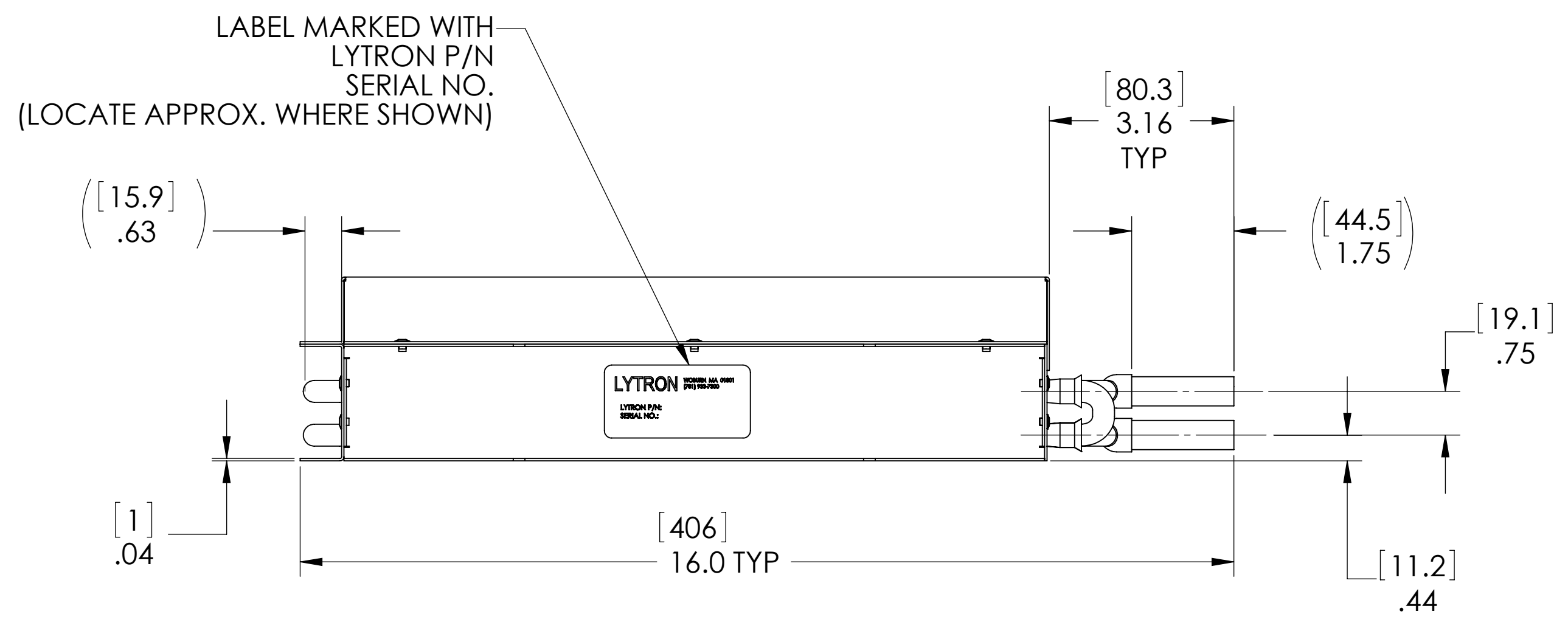

- NOTES:
1. PRESSURE TEST ASSEMBLY AT 150 PSIG.
  2. DIMENSIONS IN [ ] ARE IN MILLIMETERS.

**M14-120SB1**

MATERIAL	
TUBING	COPPER
OUTER FIN	ALUMINUM
FITTINGS	COPPER
FRAME	GALVANIZED STEEL

UNLESS OTHERWISE SPECIFIED		DRAWN	DATE	LYTRON INCORPORATED WOBBURN, MASSACHUSETTS				
ANGULAR DIMENSIONS $\pm 5^\circ$ SURFACE ROUGHNESS (3.2 $\mu$ ) BREAK EDGES .010 (25mm) MAX. REMOVE ALL BURRS		CHECKED		DRAWING TITLE				
TOLERANCE ON DECIMALS		APPROVED		HEAT EXCHANGER ASSY				
INCH .X .XX .XXX mm $\pm .1$ $\pm .06$ $\pm .020$		APPROVED		DO NOT SCALE THIS DRAWING	SIZE	FSCM NO.	DRAWING NO.	REV
THIRD ANGLE PROJECTION		MATERIAL	SEE CHART		D	11245	S-M14-120SB1	F
DIMENSIONS AND TOLERANCING ARE PER ANSI STD Y14.5		FINISH	NONE	SCALE	1/2	WT.		SHEET 1 OF 2